

Emergency disaster shelters
 FEMA & Red Cross applications
 Construction site offices and worker housing
 Mining worker offices and worker housing
 Worker housing for off-shore gas and oil drilling rigs
 Mancamps
 Worker housing for farms, vineyards, agriculture, etc.
 Hunting and fishing camp lodging
 Homeless shelters
 Work shops
 Artist studios
 Home child care centers
 Guest cabins
 Portable press rooms for event coverage
 VIP lounges for special events
 Extreme weather shelters
 Farm workshops
 Tack rooms
 Storm shelters
 Portable medical clinics
 Migrant worker temporary housing
 Sleeping quarters for forest service fire fighters
 Remote security outposts
 Ecological campsites

Instant Mother-In-Law cottages
 Portable emergency clinics
 Temporary classrooms
 Refugee camps
 Overflow housing for low-risk prisoners
 On-site half-way housing for penal system
 Worker housing for the construction of pipelines
 Military and police command posts and offices
 Storage for FBI, DEA and Police evidence
 Safari camps
 Temporary student dorms
 Game rooms
 Music studios
 Exercise rooms
 Housing for workers and actors for remote film productions
 Floating shelters with pontoons added
 Housing for workers when building new airports
 Housing for workers on railroad projects
 Underground bomb shelters
 Survival shelters
 Race track offices or lounges
 Wine cellars/tasting rooms
 Drafting and design offices
 Housing for border patrol



GLOBAL

Portable Buildings, Inc.

Global Portable Buildings, Inc. manufactures rugged, easily transportable, multi-purpose, new buildings designed for a wide range of uses, in virtually any environment or location.

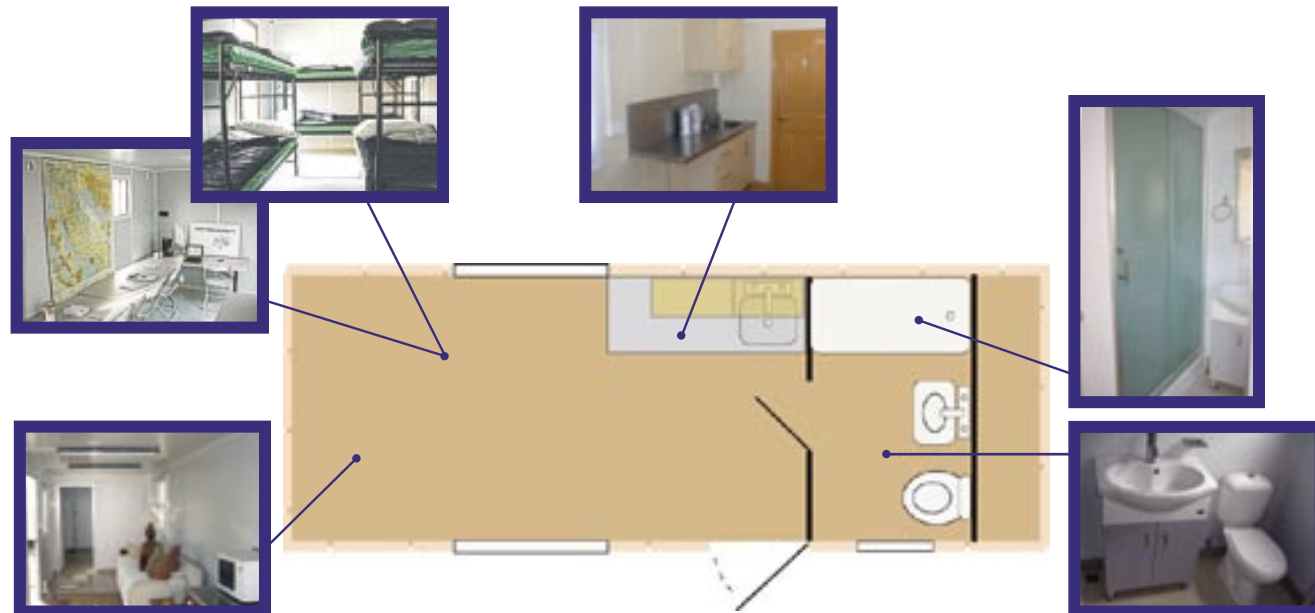

Basic Features

- Durable, heavy duty steel construction to ISO standards
- Large, 5mm-thick windows with screens, blinds, removable metal window shutters
- Fully finished rigid 2" insulated walls and ceilings
- Utility room with shelf
- Transportable by truck, rail, ship, helicopter or air cargo plane
- Requires no foundation; can withstand up to 100 MPH winds without anchoring, and Category 5 hurricane winds with anchoring
- Can also withstand tornadoes, earthquakes and other natural disasters

Electrical Features

- Complete 110v/220v electrical system with fluorescent light fixtures (3 per 20' and 6 per 40'), wall plug receptacles, etc.
- Extraction fan with on/off switch
- Telephone connection with standard modular hookup

Distributed By:



www.GlobalPortableBuildings.com info@GlobalPortableBuildings.com
 3000 B Dutton Avenue, Santa Rosa, California 95407 USA
 Tel 707 547 0840 Fax 707 577 8649

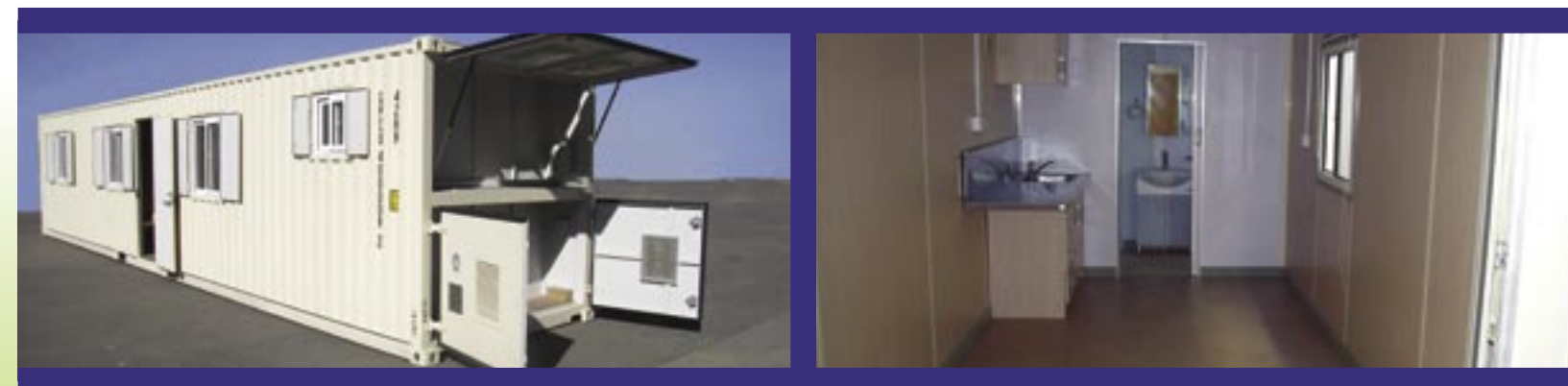



options

Global Portable Buildings have been designed to accommodate a variety of uses that can be adapted for temporary, semi-permanent or permanent use.

Complete bathroom and kitchen for the 20' and 40'

- Toilet with plumbing and toilet paper holder
- Bathroom wall with sliding door
- Shower with plumbing and towel rack
- Glass sliding shower door
- Bathroom sink with plumbing, hot and cold faucet, and towel rack
- Vanity wall cabinet with mirrored door above the sink
- Kitchen counter 24" x 72" with backwall splash guard
- Kitchen sink with hot and cold faucet and plumbing
- Storage cabinets above and below counter top

options

Bedroom for the 40' only

- Bedroom wall
- Bedroom door
- Bedroom closet with sliding doors and shelves

Complete solar system for the 20' and 40'

- Polycrystalline silicon panel
- Controller/regulator
- 12v DC light fixture with on/off switch (3 for the 20' and 6 for the 40')
- Circuit breaker or fuse panel
- 12v DC adapter plug (to recharge cellular phone)
- (100 amp) maintenance-free batteries

Decorative roof for the 20' and 40'

- Complete fiberglass roof shipped inside unit

multi-units



Many 8' x 40' units can be linked together

shower units

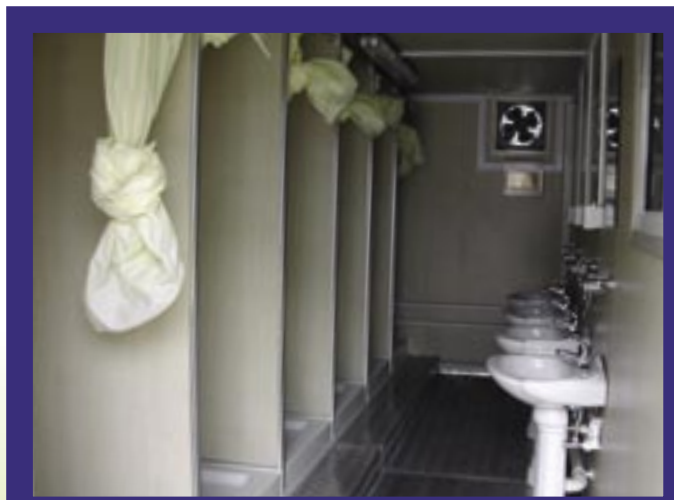

Six showers with four sinks

foldable storage units



8' x 10' (16 folded fit into one 8' x 40' container)